

PARTS LIST

Image Number	Note	Part Number	Description	QTY per Product
1		U3002XX	840 UPHOLSTERED TOP	
1	B	228401	TABLE FRAME 840/845	2
1	B	701010	1X2X18 RECT INSERT CAP/GLIDE LT.GRAY	4
1	B	566519	SCREW-MACH 1/4-20 X 2 1/2 PAN PHILLIP M/S ZINC	4
1	B	566507	SCREW-MACH 1/4-20 X 3 RND PHILLIP M/S ZINC	4
1	B	566306	WASHER-1/4 X 1 FENDER WASHER ZINC	4
2		228403	WELDED BRACE ASSMEBLY 840/845	1
2		566401	BOLT-CARRIAGE 1/4-20 X 1 1/2 ZINC	4
2		566204	NUT-1/4-20 HEX NYLON LOCKNUT ZINC	4

NOTES

Note	Description
A	XX- Use color code for specific part number i.e. 02 - Royal Blue
B	Part is included with 840 Upholstered Top

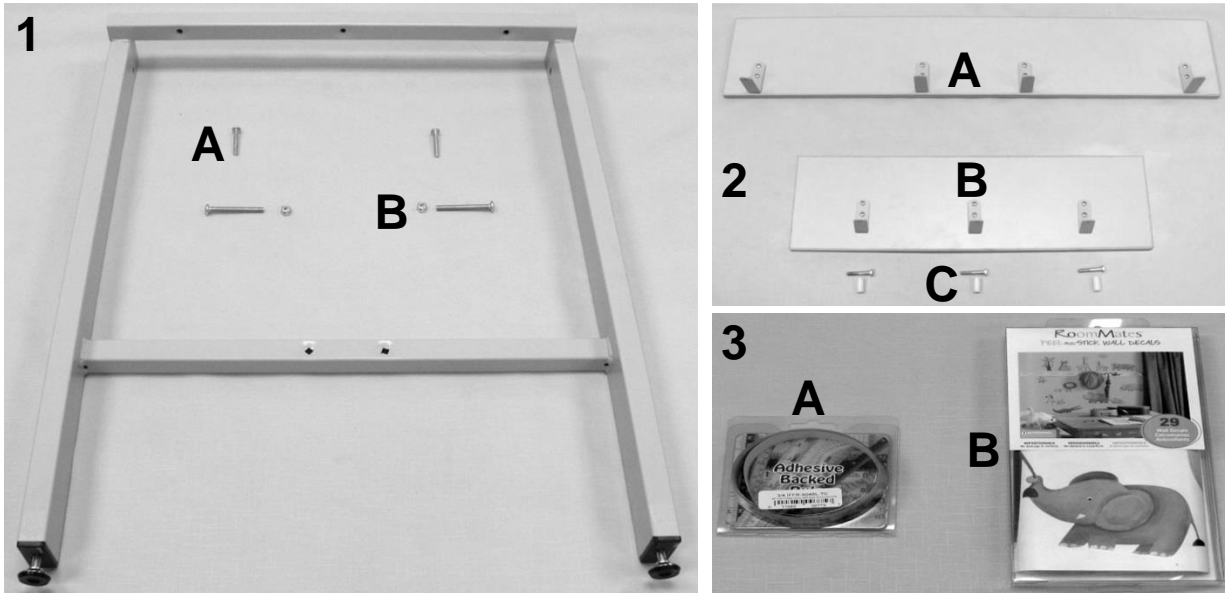

PARTS LIST

Image Number	Note	Part Number	Description	QTY per Product
1		222710K	WELDED LEG ASSM. KIT 30" (850 style)	2
1	A	222710	WELDED LEG ASSM. 30" (850 style)	1
1	A	500350	GLIDE NON-SWIVEL ZINC 5/16X1" NP LN	2
1	A	501065	1"x2" METAL GLIDE INSERT;18 GAUGE;5/16-18 THREAD	2
1A	A	566506	SCREW-MACH 1/4-20 X 1 1/2 RND PHIL M/S ZINC	2
1B	A	566519	SCREW-MACH 1/4-20 X 2 1/2 PAN PHILLIP M/S ZINC	2
1B	A	566204	NUT-1/4-20 HEX NYLON LOCKNUT ZINC	2
2A		268403K	RETAINER 840, BACK ASSM. KIT	1
2A	A	268403	RETAINER 840, BACK	1
2A	A	228407	RETAINER BRACKET 840	4
2A	A	566306	WASHER-1/4 X 1 FENDER WASHER ZINC	4
2A	A	566507	SCREW-MACH 1/4-20 X 3 RND PHILLIP M/S ZINC	4
2A	A	566547	10 x 1/2 Pan Phil T/S Z/P	8
2B		268415K	RETAINER 840, SIDE ASSM. KIT	2
2B	A	268415	RETAINER 840, SIDE	1
2B	A	228407	RETAINER BRACKET 840	3
2B	A	566547	10 x 1/2 Pan Phil T/S Z/P	6
2C	A	566404	BOLT-1/4-20 X 1 3/4 HEX CAP SREW GR 2 ZINC	3
2C	A	566315	WASHER-1/4 NYLON SPACER (.257 X .5 X 1.0)	3
3A		705840	MYLAR TAPE MEASURE LEFT TO RIGHT, 3/4" X 40"	1
3B		007500	DECALS - PED. TABLE	1

NOTES

Note	Description
A	These parts are included in the above listed kit.

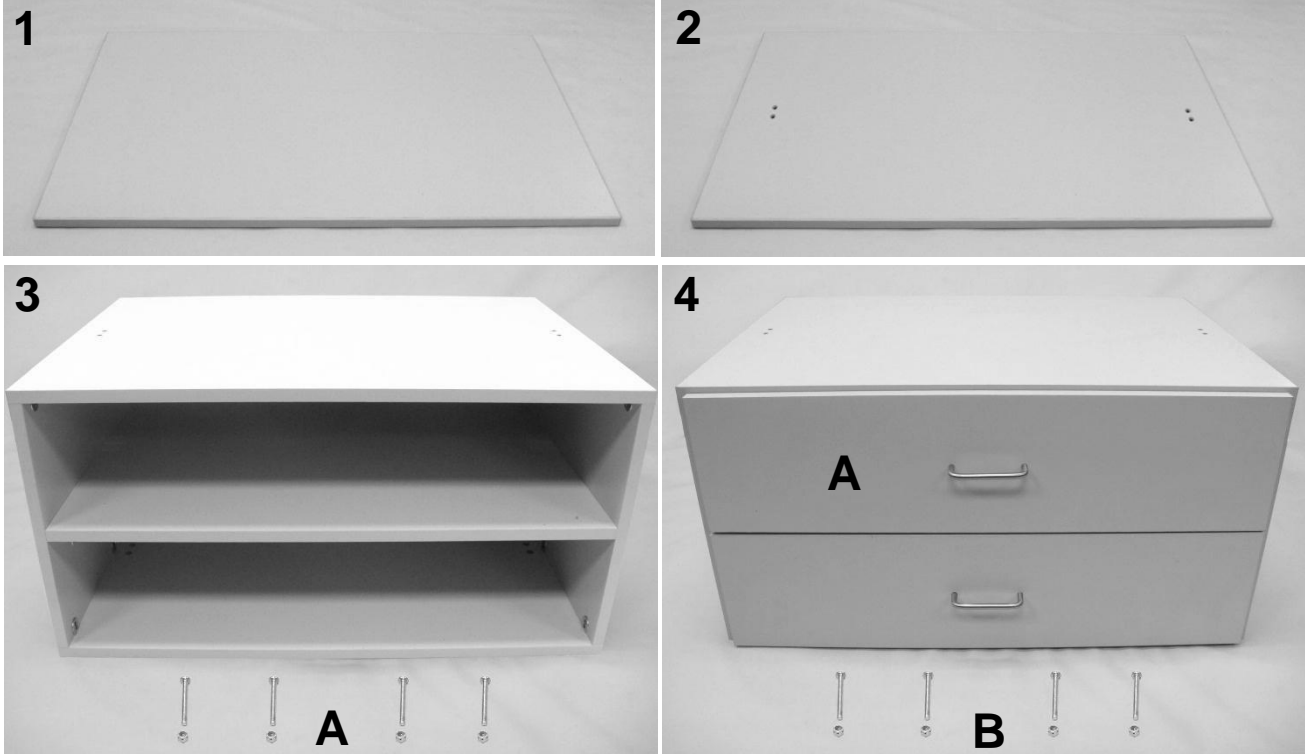

PARTS LIST

Image Number	Note	Part Number	Description	QTY per Product
1		268410K	840/845 SHELF KIT	1
1	A	268410	840/845 SHELF	1
1	A	705600	DOUBLE SIDED FOAM TAPE, 3/4" X 36YDS	1 ft.
2		268405	840/845 MODULE SHELF	1
3		266780K	850/851/856 CABINET MODULE ASSM. KIT	1
3A	A	266780	850/851/856 CABINET MODULE	1
3A	A	566519	SCREW-MACH 1/4-20 X 2 1/2 PAN PHILLIP M/S ZINC	4
3A	A	566204	NUT-1/4-20 HEX NYLON LOCKNUT ZINC	4
4		266730K	850/851/856 DRAWER MODULE KIT	1
4	A	266730	850/851/856 DRAWER MODULE	1
4B	A	566519	SCREW-MACH 1/4-20 X 2 1/2 PAN PHILLIP M/S ZINC	4
4B	A	566204	NUT-1/4-20 HEX NYLON LOCKNUT ZINC	4
4A	A	266760K	850/851/856 MODULE DRAWER ASSM. KIT	1
4A	A	266760	850/851/856 MODULE DRAWER ASSM	1
4B	A	566519	SCREW-MACH 1/4-20 X 2 1/2 PAN PHILLIP M/S ZINC	4
4B	A	566204	NUT-1/4-20 HEX NYLON LOCKNUT ZINC	4

NOTES

Note	Description
A	These parts are included in the above listed kit.